

# GRACE DESIGN

## Spacebar *Precision Microphone Positioner*

User Manual, Revision A, February 26, 2009

### *Table of Contents*

<a href="#">Spacebar Components.....</a>	<a href="#">2</a>
<a href="#">Setup Procedure.....</a>	<a href="#">4</a>
<a href="#">Changing the mic holder height.....</a>	<a href="#">5</a>
<a href="#">Changing the horizontal bar length.....</a>	<a href="#">5</a>
<a href="#">Exploded parts diagram.....</a>	<a href="#">6</a>
<a href="#">Revision history.....</a>	<a href="#">7</a>

The Grace Design Spacebar microphone positioner allows for precise and repeatable setting of microphone capsule spacing, angle of incidence, and rotation around the x axis. With precision scales for angle and distance engraved on the Spacebar components, it becomes easy to make perfectly repeatable stereo microphone setups.

As well as being able to precisely set microphones in standard stereo configurations (i.e. XY, ORTF, NOS, and AB 50cm), the Spacebar allows for exact settings through the entire continuum of angle and spacing. This allows the user to adjust the stereo microphone array and tailor the pickup field to suit virtually any recording environment.

We highly recommend *The Stereophonic Zoom* by Michael Williams, a technical paper that provides detailed information on the relationship between angle of incidence, capsule spacing, and the effective angle of the recorded sound field. It is a very useful reference that can greatly increase the flexibility of your stereo microphone techniques. *The Stereophonic Zoom* can be downloaded from:

<http://www.microphone-data.com/pdfs/Stereo%20zoom.pdf>

The Spacebar system is precision fabricated from machined aircraft aluminum, brass, and stainless steel. If properly cared for it should last a lifetime.

In the event that you encounter any technical or operational difficulties with this or any Grace Design product, please feel free to contact us at 303-443-7454. Our office hours are from 9 to 5, Monday through Friday, MST. Or you can e-mail any questions to: [info@gracedesign.com](mailto:info@gracedesign.com)

# Spacebar Components

The Spacebar system consists of a center stand clamp, horizontal bar, and microphone holders.

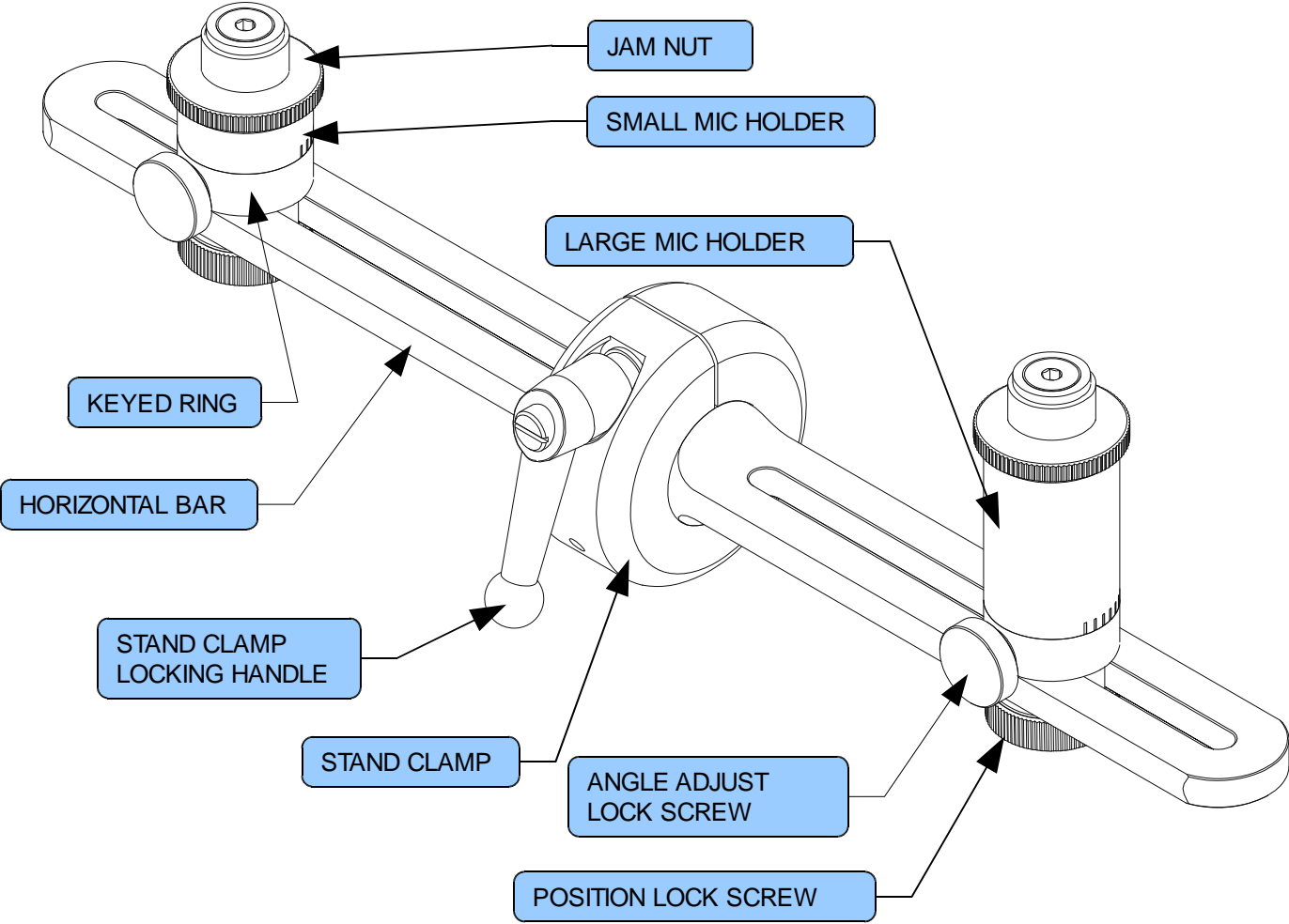

*Drawing 1: Spacebar components*

1. The horizontal bar comes in two sizes: 30cm for the SB-30 and 66cm for the SB-66. The 30cm and 66cm horizontal barS are interchangeable in the field. The maximum microphone holder spacing is as follows:

Model	Minimum spacing	Maximum spacing
SB-30	7cm (2.75")	26cm (10.2")
SB-66	7cm (2.75")	61cm (24")

2. The stand clamp mounts on a standard 5/8"-27 microphone stand thread. Note: the threaded section of the microphone stand should not be longer than 7/16". Threading the stand further than 7/16" into the stand clamp can cause the horizontal bar to bind and not rotate freely.
3. The microphone holders are secured to the horizontal bar by the position lock nuts. Loosening these nuts will allow the microphone holders to slide side to side for adjusting the microphone spacing. The horizontal position can be adjusted with 5mm precision by using the ruler on the front of the horizontal bar. Note that these rulers are for reference as the actual capsule spacing will need to be determined with a measuring tape or ruler. The SB-30 and SB-66 are both supplied with two microphone holder assemblies and an additional tall microphone holder. The taller microphone holder body can be used to raise one microphone to avoid interference if the mic spacing requires that the microphone bodies overlap. See [Changing the mic holder height](#) later in this manual. Additional microphone holders can be purchased if more than two microphones are to be mounted to the Spacebar.

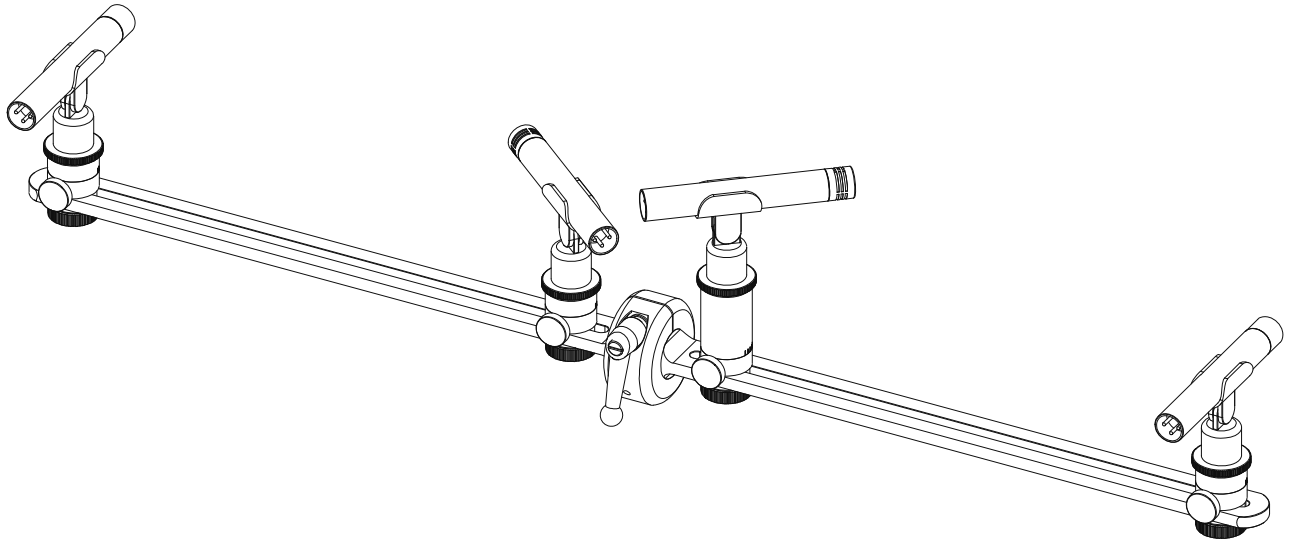

*Drawing 4: SB-66 with multiple mic holders*

4. When the position lock nuts are loose the microphone angle can be adjusted by loosening the angle adjust locking screws. The angle of incidence can be adjusted with 5° precision by using the angle scale on the front of the microphone holder.

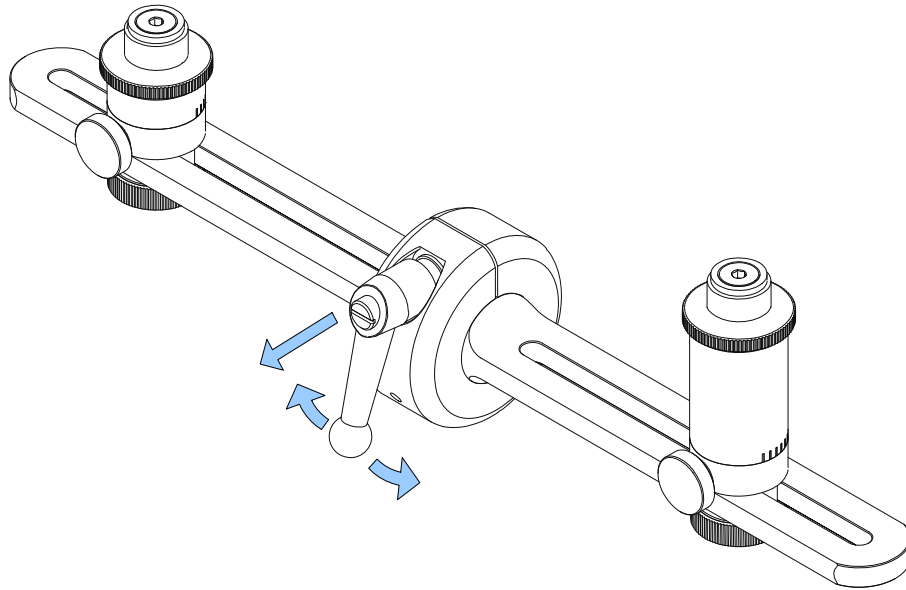

*Drawing 2: Adjusting the position of the clamp handle*

5. The vertical angle of the microphones can be adjusted by loosening the clamp handle and then rotating the horizontal bar to the desired angle. For reference there is a  $\pm 90^\circ$  scale on the side of the stand clamp. The stand clamp locking handle is adjustable and is set from the factory to provide a good clamping force with the handle pointing downward. To adjust the angle of the handle pull the handle back from the stand clamp while rotating. When released, the handle will snap back and engage in the new position.

## *Setup Procedure*

1. On the mic holder assemblies loosen the position locking nut and the angle locking screw and set the angle to  $0^\circ$ . Tighten both again.
2. Thread on the microphone clips for your desired microphones but do not tighten all the way. Put the microphones in the clips and while looking down on the Spacebar from above point the mics so that they are pointing straight forward and are perpendicular to the horizontal bar. While holding the microphone in this position turn the jam nut counter clockwise until the clip is securely locked.

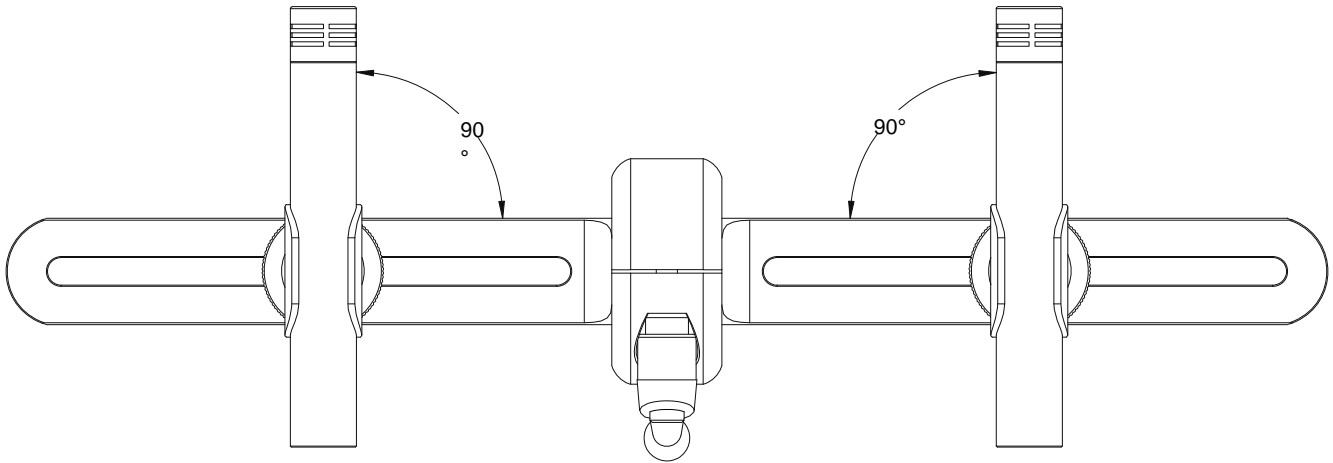

*Drawing 3: Microphone alignment, top view*

3. Unlock the position locking nut and the angle lock screw and rotate the clip to the desired angle of incidence. Re-lock the angle lock screw.
4. Mount the microphones and, using a tape measure or ruler, adjust the spacing between capsules.
5. Lock the position locking nuts.

### *Changing the mic holder height*

1. To change between the standard height mic holder and the tall mic holder loosen and remove the Position Lock Nut while holding the microphone holder assembly so that it does not fall.
2. Loosen the Angle Lock Screw and remove the microphone holder body from the keyed ring.
3. Insert the desired microphone holder body into the keyed ring and tighten the Angle Lock Screw.
4. Place the microphone holder assembly into the slot on the horizontal bar and install the Position Lock Screw to secure the assembly.

### *Changing the horizontal bar length*

1. Refer to the [exploded parts diagram](#) at the end of this manual.
2. To remove the horizontal bar loosen the 8-32 set screw (H407) with a 5/64" hex wrench. Turn the set screw counter clock wise about 4 turns.
3. Loosen the clamp handle and slide the horizontal bar out of the stand clamp.
4. Insert the desired horizontal bar into the stand clamp and center it but do not tighten the clamp yet.
5. Tighten the set screw with the hex wrench until the screw stops then loosen the set screw by ¼ turn. The horizontal bar should rotate freely but not slide out of the stand clamp.

# Exploded parts diagram

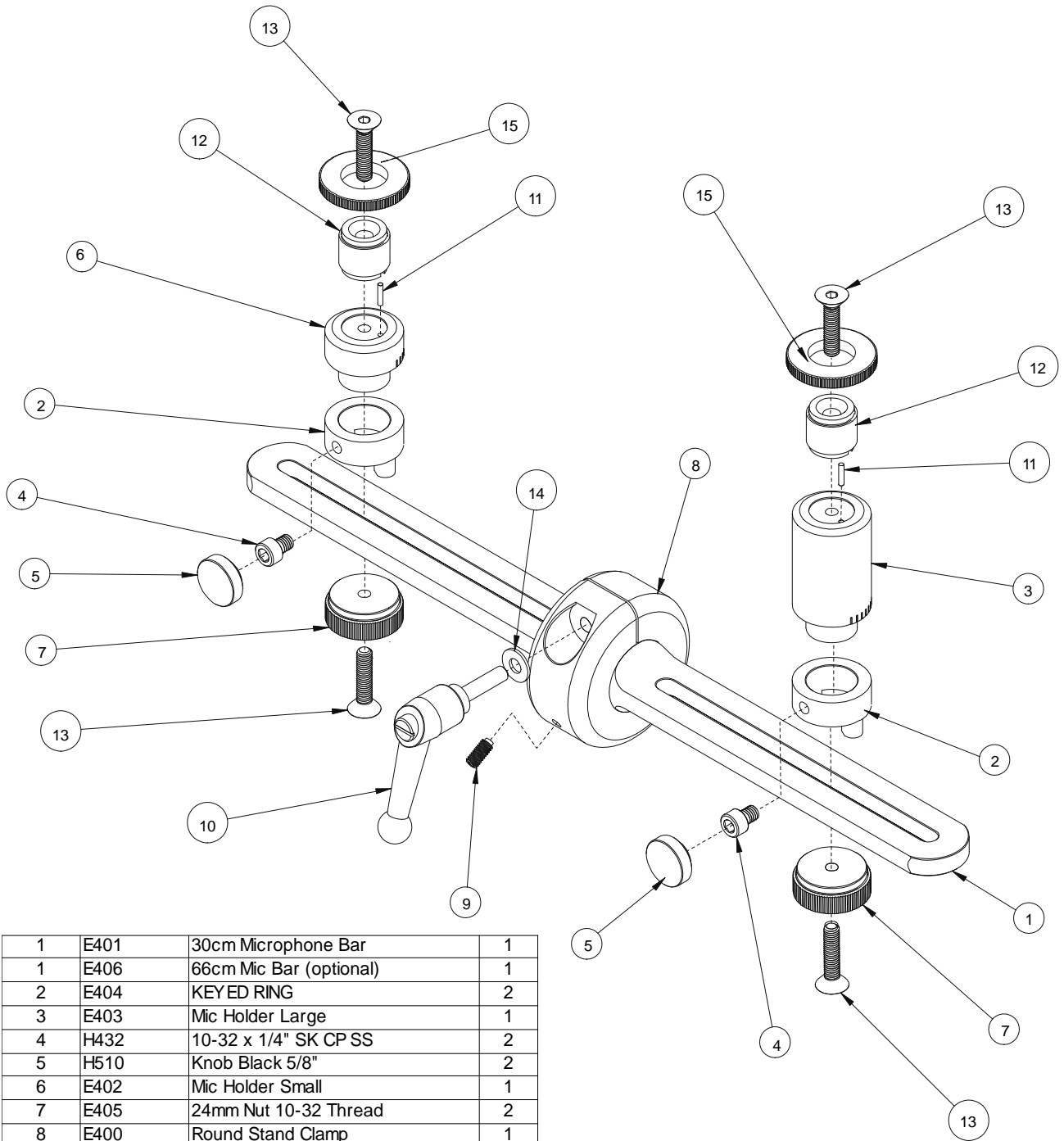

1	E401	30cm Microphone Bar	1
1	E406	66cm Mic Bar (optional)	1
2	E404	KEYED RING	2
3	E403	Mic Holder Large	1
4	H432	10-32 x 1/4" SK CP SS	2
5	H510	Knob Black 5/8"	2
6	E402	Mic Holder Small	1
7	E405	24mm Nut 10-32 Thread	2
8	E400	Round Stand Clamp	1
9	H407	8-32 x 3/8" Set Screw Pilot Point	1
10	H512	Adjustable Handle 10-32 x .78" stud	1
11	H520	Round Pin 1/16" x .3"	2
12	H514	5/8-27 Threaded Boss	2
13	H436	10-32 x 7/8" FL SC SS	4
14	H459	#10 Flat Washer Bronze	1
15	H515	5/8-27 24mm Nut	2

Drawing 4: Exploded Parts Diagram

# Revision History

Rev.	Description	Date	Initials
A	Initial release	01/30/09	MBG